

XL5-40

4-inch Direct Thermal
Linerless Desktop Label Printer

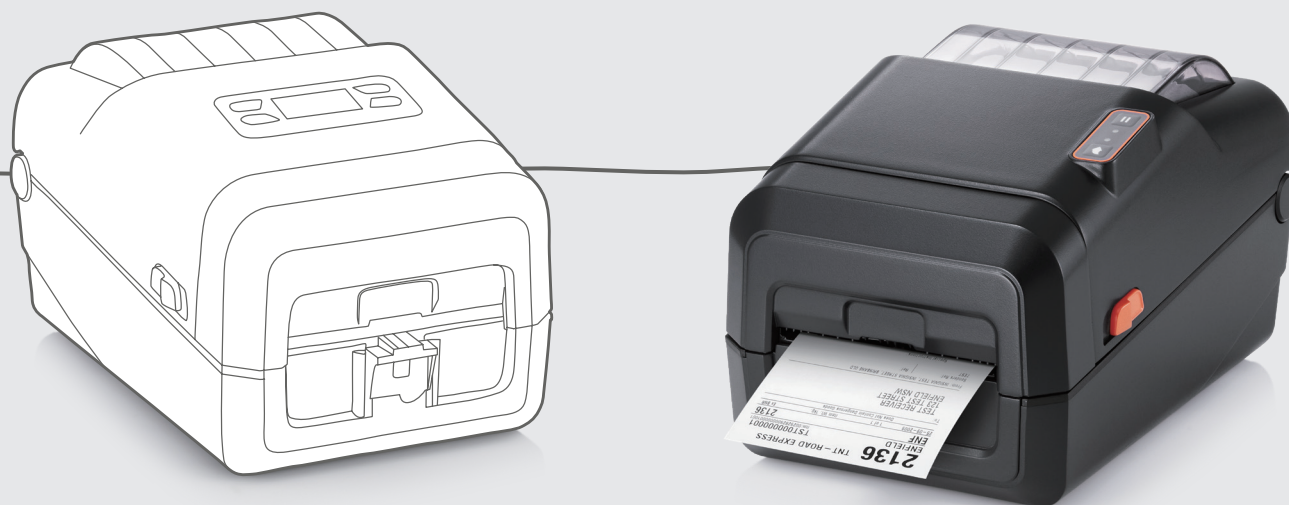

Extreme Reliability, Eco-Friendly and Cost Efficient



Extreme Reliability

- Anti-jamming, anti-curling and two long-lasting platen rollers equipped
- Specifically designed paper path
- Guillotine cutting system with a peel-off sensor, Taken Sensor™
- Reliability at its finest in any harsh environment with BIXOLON supply, B-linerless™
- Compatible with many certified linerless media by BIXOLON

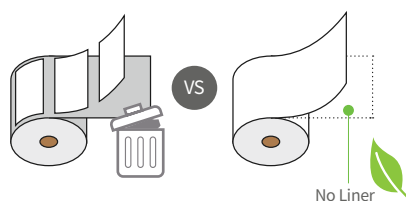

Green Solutions

- Up to 40% more label length available on a linerless paper per roll compared to lined media
- Flexible to print multiple length media on a roll
- Cutting storage and transportation expenses while reducing down time
- Nil to landfill silicon backed liner



Functional Operations

- Fast linerless printing speed up to 6ips (152mm/sec).
- Dual-mode Bluetooth (V4.2 Classic and LE) or Dual-band WLAN (5GHz and 2.4 GHz) connectivity
- Twin function™ and free advanced-level label editing software
- SoftAP & Smart Connection™ - Easy Wi-Fi setup
- XPM™ & XCM™ - Web-based printer management software and connection app

XL5-40

4 inch Direct Thermal Linerless Desktop Label Printer



Specifications

Printer Specifications

Print Method

Direct Thermal

Print Speed

XL5-40: Up to 6 ips (152 mm/sec)

XL5-43: Up to 5 ips (127 mm/sec)

Print Resolution

XL5-40: 203dpi

XL5-43: 300dpi

Print Width

XL5-40: Up to 108 mm

XL5-43: Up to 105.7 mm

Print Length

30 ~ 1,000 mm

Sensor

Gap(Fixed) / Black mark(Adjustable),

Head Open, Paper Taken Sensor

Media Characteristics

Media Type

Linerless : Continuous, Black Mark

Linered : Gap, Black Mark, Fan-Fold

Media Width

20 ~ 114mm

Media Roll Diameter

Up to 127mm

Media Thickness

0.09 ~ 0.20mm

Inner Core

38.1 mm (1.5 inch) - Recommended

25.4 mm (1 inch)

Physical Characteristics

Dimensions (WxDxH)

186 x 287.7 x 173 mm

(7.32 x 11.33 x 6.81 inch)

Weight

2.8kg (6.17lb.)

Electrical

EnergyStar Certified,

External Power Adaptor 100-240V AC, 50/60Hz

Display

Standard: None

Optional: FSTN LCD (200 x 100 pixels)



Performance Characteristics

Memory

Standard: 64 MB SDRAM, 128 MB Flash

Optional: ① 64 MB SDRAM, 128 MB Flash

② 256 MB SDRAM, 256 MB Flash

Interface

Standard: USB2.0 + USB Host

Optional: ① USB2.0 + USB Host + WLAN

② USB2.0 + USB Host + Bluetooth

③ USB2.0 + USB Host + Serial +

Ethernet

④ USB2.0 + USB Host + Serial +

Ethernet + WLAN

⑤ USB2.0 + USB Host + Serial +

Ethernet + Bluetooth

WLAN: Built-in type, 802.11a/b/g/n
(2.4G and 5G)

Bluetooth: Built-in type, V4.2 Classic / LE, Class
1, MFi certified

Ethernet: 10/100Mbps

Real Time Clock

Supported (Option)

Environment Characteristics

Temperature

Operating: 0 ~ 40°C (32 ~ 104°F)

Storage: -20 ~ 60°C (-4 ~ 140°F)

Humidity

Operating: 10 ~ 80% RH

Storage: 10 ~ 90% RH

Software

Emulation

SLCS™, BPL-Z™ (ZPLII), BPL-E™ (EPL)

Driver / Utility

Windows Driver (Europlus / Seagull),

Linux / Mac CUPS Driver,

Virtual COM USB / Ethernet Driver,

Utility Program, OPOS / JPOS Driver,

Bartender Ultralite for BIXOLON,

Label Artist-II™

SDK / Plugin

Android / iOS / Windows SDK, Linux SDK,

Chrome SDK, Xamarin SDK

Application

Label Artist™ Mobile (Android, iOS),

mPrint App (iOS),

mPrint Server (Windows, iOS)

MDM (Optional)

BIXOLON Profile Manager

- XPM™, XCM™ (Windows, Android)

Fonts / Graphics / Symbologies

Fonts

Bitmap Fonts (SLCS™, BPL-Z, BPL-E) /

Scalable Fonts (SLCS™, BPL-Z) /

Unicode supported (UTF-8, UTF-16LE,

UTF-16BE)

Graphics

Supporting user-defined fonts, graphics,

formats and logos

Barcode Symbologies

1D: Codabar, Code 11, Code 39, Code 93,

Code 128, EAN-13, EAN-8, Industrial 2-of-5,

Interleaved 2-of-5, Logmars, MSI, Plessey,

Postnet, GS1 DataBar (RSS-14),

Standard 2-of-5, UPC/EAN extensions,



UPC-A, UPC-E, IMB

2D: Aztec, Codablock, Code 49, Data Matrix,

MaxiCode, MicroPDF417, PDF417, QR code,

TLC 39

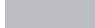
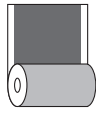
B-linerless™

Product Line		
	Nonstick Coating	
	Adhesive Coverage	
	Black Marks	
Model Name		BL-PL100-02
Applicable models		XL5-40
Dimensions of the product	width (mm)	100
	length (m)	100
Number of rolls in carton		18